

Le Boreal & Le Soleal

Arctic Cruise Adventure: In Search of the Polar Bear | Ultimate Iceland & Greenland Cruise

The Northwest Passage: From Greenland to the Bering Sea | Grand Arctic Voyage | Wonders of Japan Cruise

Category 1
Classic stateroom

Category 2
Deluxe stateroom

Category 3
Premier stateroom

Category 4
Superior stateroom

Category 5*
Prestige suite

Category 6*
Premier two-room suite

Category 7*
Prestige two-room suite

Category 8*
Owner's suite

*Butler service included

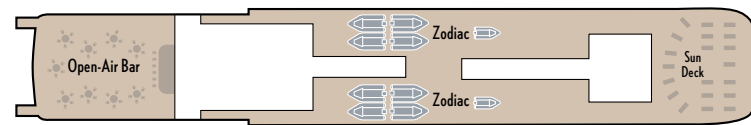

DECK 7

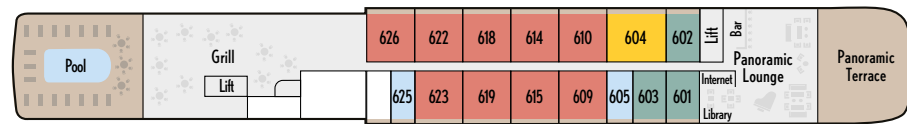

DECK 6

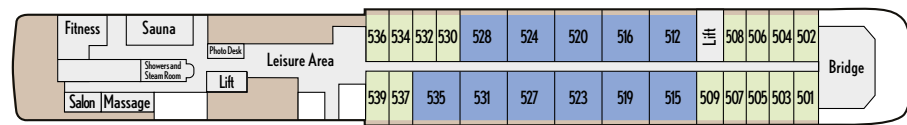

DECK 5

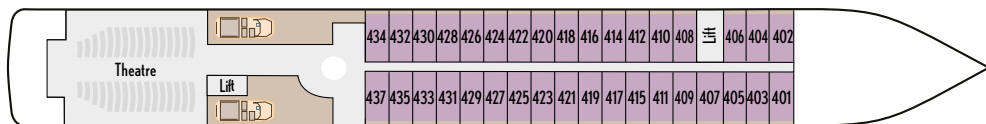

DECK 4

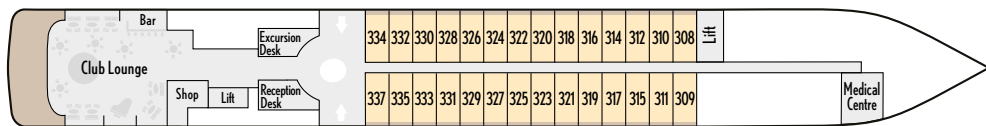

DECK 3

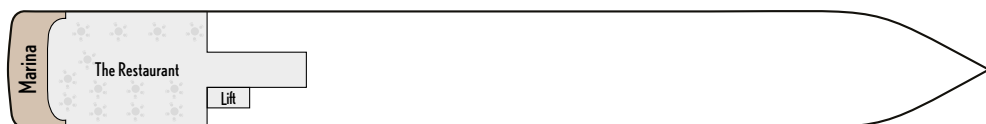

DECK 2

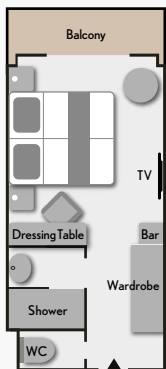

Categories 1-4
Staterooms

Cabin: 18.5 sqm | Balcony: 4 sqm



Ship details

- ▶ Overall length: 142 metres
- ▶ Beam: 18 metres
- ▶ Draft: 4.66 metres
- ▶ Average speed: 14 knots
- ▶ Passenger decks: 6
- ▶ Passenger capacity: 264 (limited to 199 exclusively on A&K charters)
- ▶ Crew and A&K staff: 155 (staff-to-guest ratio of 1 to 1.3)
- ▶ Gross tonnage: 10,992 UMS
- ▶ Electric motors: 2 x 2,300 KW
- ▶ Standards: USPHS – US Coast Guard’s Rules Comfort Class 1 Clean-Ship Certification (meets or exceeds all IMO, EPA, IAATO and AECO operating standards)
- ▶ Technology: Advanced dynamic positioning system and highly efficient stabilisers
- ▶ Flag: French
- ▶ Language: English on A&K charters

Amenities

- ▶ Private balcony with every guest stateroom and suite (exclusive on A&K charters only)
- ▶ Complimentary butler service with every suite (exclusive on A&K charters, includes welcome champagne, nightly canapés, packing/unpacking on request, and more)
- ▶ Stateroom and suite amenities include a hair dryer, large wardrobe and ample storage, safe, alarm clock, and Hermès bath products
- ▶ Stateroom and suite electricity: 220v outlets – Europe two-prong style (plus two 110/220 US outlets)
- ▶ Sun Deck and multiple outer deck observation areas
- ▶ Outside heated pool
- ▶ Library with selection of books and games
- ▶ Two restaurants: Main and indoor/outdoor Grill
- ▶ Open bar with beer, wine, spirits, cocktails, soft drinks, coffee, tea, and mineral water (excludes premium wines and spirits)
- ▶ Two lounges with bars: Club Lounge with live music and Panoramic Lounge with terrace
- ▶ Complimentary 24-hour room service
- ▶ Complimentary in-cabin breakfast (upon request)
- ▶ Three passenger lifts
- ▶ Fitness centre with Kinesis® wall
- ▶ Full-service spa with salon, sauna, and steam room
- ▶ Theatre with comfortable seating for all guests
- ▶ Boutique shop
- ▶ 24-hour medical facilities with certified doctor
- ▶ A&K’s complimentary Traveller’s Valet® laundry service
- ▶ Complimentary wireless internet on A&K charters (due to remote destinations, access and speed vary)

BUTLER SERVICE INCLUDED

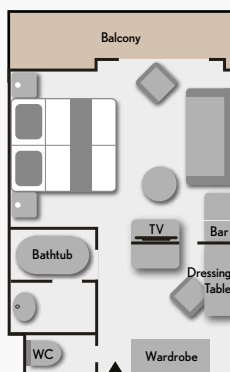

Category 5
Prestige suites
Cabin: 27 sqm | Balcony: 5 sqm

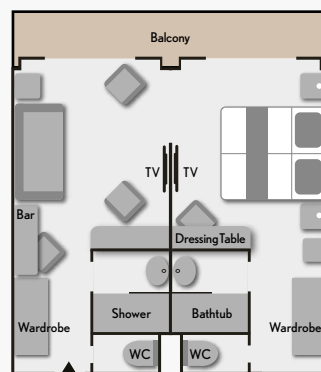

Categories 6-7
Premier and prestige two-room suites
Cabin: 37 sqm | Balcony: 8 sqm

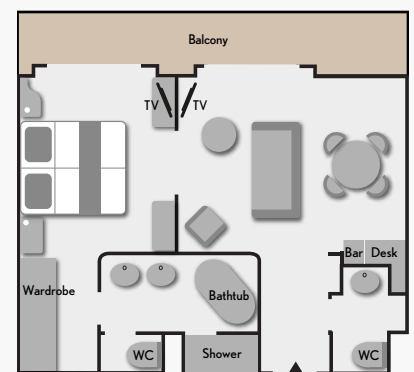

Category 8
Owner's suite
Cabin: 45 sqm | Balcony: 9 sqm